

Block Plan - Existing

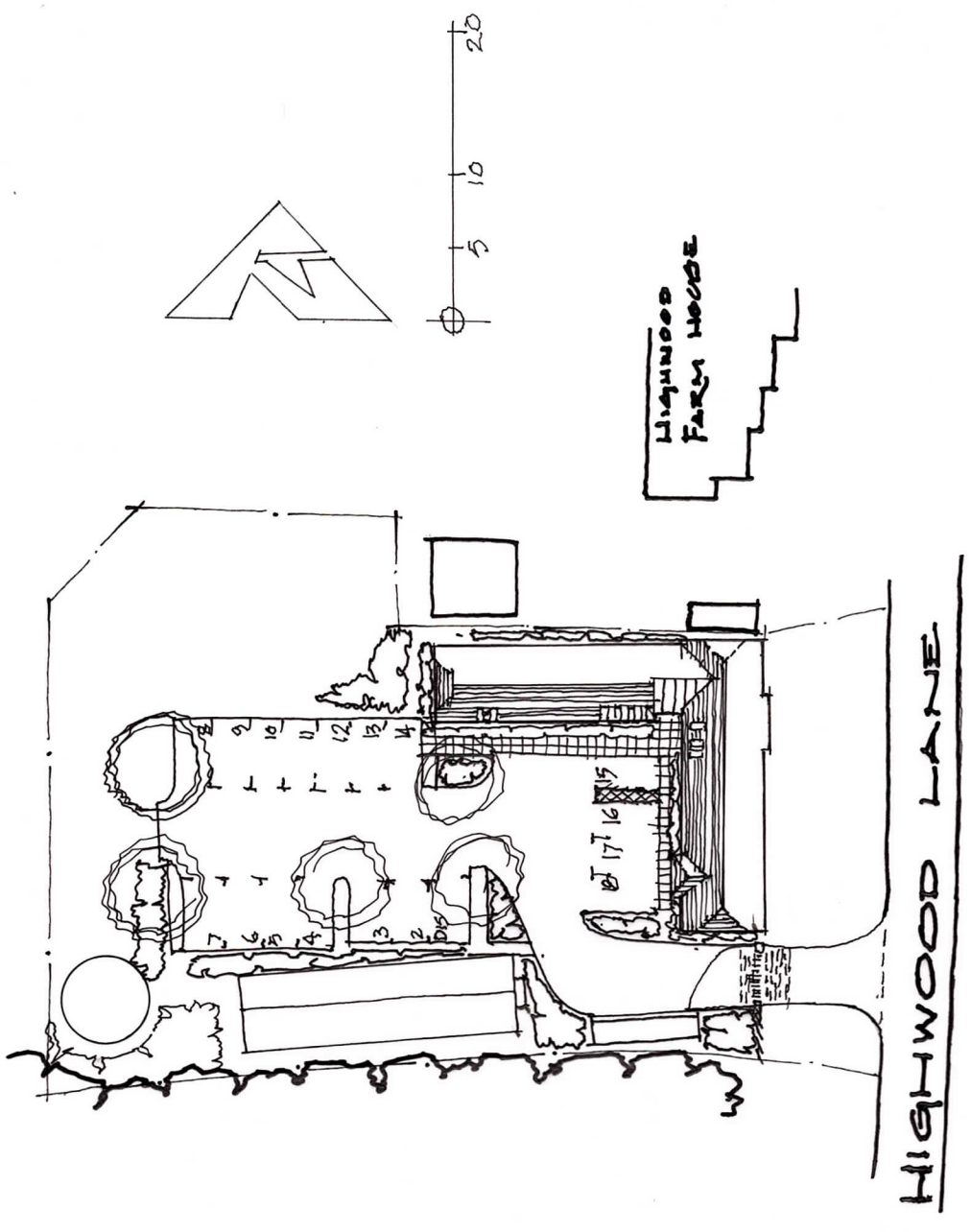

Block Plan. 1500 @ A4

JON DALE ARCHITECT LTD.

Jon Dale RIBA 7 Crestwood View, Eastleigh, Hampshire, SO50 4NF Tel: 07787 575126 E-mail: jondalearchitect@gmail.com

Project: TIBBLES BARN, HIGHWOOD LANE, ROMSEY  
 Title: EXISTING AND PROPOSED BLOCK PLANS

Scale: 1:500 @ A4  
 Date: Aug 10  
 Drawn: [Signature]  
 Checked: [Signature]  
 Job No.: JS/10/10-15  
 Drawing No.: JS/10/10-15/3  
 Revision: